

These are exciting times for the St George's Healthcare NHS Trust as we move forward with plans to become a NHS Foundation Trust and work towards integrating with Community Services Wandsworth. Patients care is at the heart of everything we do and in 2009 we were proud to be named 'Large Trust of the Year' by Dr Foster Intelligence, the publisher of the Hospital Guide. 2010 has seen us continue to develop our services with the launch of a major trauma centre, one of only four serving London and the opening of a specialist hyper-acute stroke unit. If we are to continue deliver improved care to the people of Wandsworth then we will need to invest in developing new services.

It has now been nearly two years since the Bolingbroke Hospital was closed and its services moved to modern facilities at St Johns Therapy Centre in Battersea.

## Our next challenge is to invest in and improve our services by raising the most money we can from the sale of the vacant Bolingbroke site.

St George's is moving ahead with plans to sell the site within the 2010/11 financial year. The sale is expected to raise millions of pounds which will be invested in improving healthcare for the 1.3 million people that the trust serves across Wandsworth and southwest London.

The trust has identified key priorities for investment following the Bolingbroke sale. These include an extension to St George's A&E department and expansion of its resuscitation department where major trauma patients are admitted. All of this will happen if we can sell the building before the end of the financial year 2010/11.

St George's will also fulfil its commitment to the local community by ensuring that NHS Wandsworth, the local primary care trust, has space to provide local healthcare services within the new development on the Bolingbroke site.

## Please let my team know what you think about our proposals.



David Astley, Chief Executive – St George's Healthcare Trust

*...a promise delivered*

## contact us to give us your feedback:

please attend our pre-application exhibition  
on **Friday 10th September 2010**  
from 6.30pm – 9.00pm

and **Saturday 11th September 2010**  
from 9.30am – 12.30pm

at **Main Hall, Chatham Hall,**  
152 Northcote Road, SW11 6RD



Alternatively you can email us at [bolingbroke.consult@stgeorges.nhs.uk](mailto:bolingbroke.consult@stgeorges.nhs.uk)  
call us on **07772 572 955 (24 hours)** or visit our website  
at [www.bolingbroke-future.co.uk](http://www.bolingbroke-future.co.uk)

"We are working closely with St George's to make sure that any planning application for the Bolingbroke includes space for NHS services. In the future we would like to see a facility that provides GP and community services which fits in with the needs of local people in this area."

**Dr David Finch – Battersea GP and Medical Director of NHS Wandsworth**

# providing funds for your healthcare future

and improving healthcare  
for the 1.3 million people  
we serve across Wandsworth  
and South West London

**your invitation** to our exhibition  
on 10th and 11th September 2010,  
find out about our plans and  
give us your views

## developing the old Bolingbroke site...

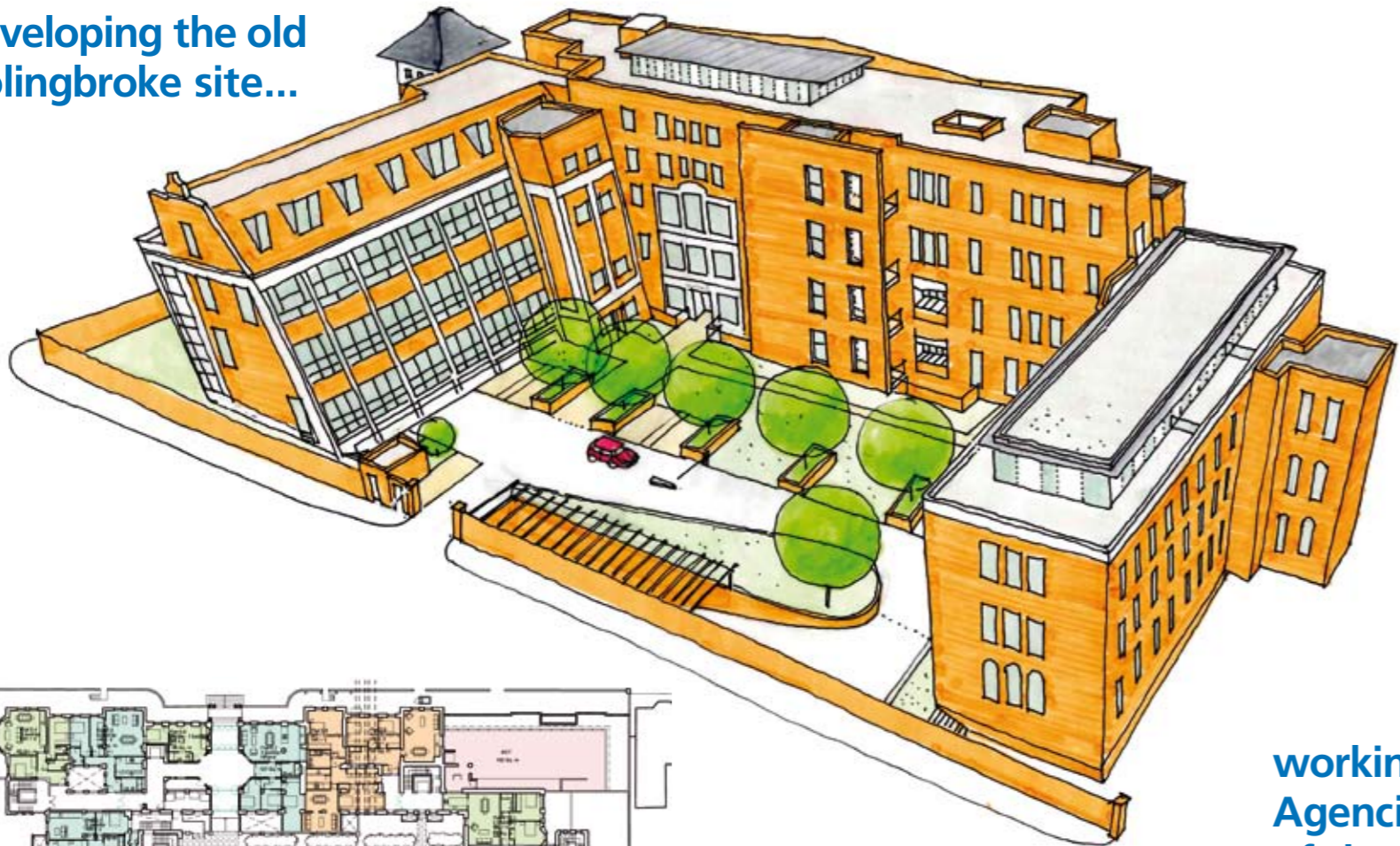

## facts about the proposed use of the old Bolingbroke site...

- 1600sq m for PCT use
- 50 apartments
- Mix of 2, 3 and 4 bed
- Included 30% affordable (social rented and shared)
- 44 underground car parking spaces (no residents permits allowed)
- 58 cycle spaces
- Sensitive landscaping
- Highest quality design and build
- No increase in height or width of building
- Traffic studies show residential and PCT use has least impact on local residents

## working closely with Heritage Agencies to preserve the best of the building

- Nursery rhyme tiles could be moved to the new PCT entrance
- Memorials will be retained in the fabric of the building

## your questions answered

### Q. What is money raised from the sale going to pay for?

A. The Trust must raise as much as possible (£ millions) to spend on healthcare for local residents, including an extension to St George's A&E department and expansion of its resuscitation department where major trauma patients are admitted.

### Q. Will there be a school on the site?

A. SGHT and its consultants have been working closely with Wandsworth Council, Neighbourhood School Campaign and Partnership for Schools and there is certainly a possibility of a school. So far no financial offer has been made to buy the site within the timescale that is vital to your Trust.

### Q. When the hospital was closed the community were promised health facilities on the site. What has happened?

A. The Trust have been working with the local Primary Care Trust to agree the space they will need for a modern facility which will house a number of local GPs. The space required by the PCT will be factored into any future use of the Bolingbroke site

### Q. Will there be a lot more traffic and parking issues on Wakehurst and Belville Roads?

A. The proposed residential development will not significantly add to the number of traffic movements in the area and of course there will be underground parking provided on the site for residents of the Bolingbroke site.

### Q. Why have the Trust decided to apply for a residential development and not put the site to some community use?

A. The Trust is mandated to achieve best price on the disposal of surplus assets. The Trust received the best professional advice available which indicated the best price would be derived from selling the building with planning permission for residential and PCT provision. At this stage no possible use of the site is ruled out so there is still the option for community use. All of the money raised from the sale will be spent on providing new healthcare for all the Trusts residents; including an extension to St George's A&E department and expansion of its resuscitation department where major trauma patients are admitted.

### Q. What happens now?

A. Local residents are being consulted on the Trusts application which will feed into the final application that will be submitted to Wandsworth Council. It is hoped that permission will be granted before the end of 2010 so that the site can be sold on and the income invested in healthcare for all the Trusts 1.3 million residents across Wandsworth and South West London.

...to improve your healthcare facilities at the new Bolingbroke site

• over 1,600 sq meters of space for local residents' healthcare

• FOUR local GP's Practices

• modern super clinic facilities

• space for additional healthcare to include:  
minor operations  
maternity services  
out patient services  
old persons services

...a promise delivered